

FLARE See Through 70 Outdoor

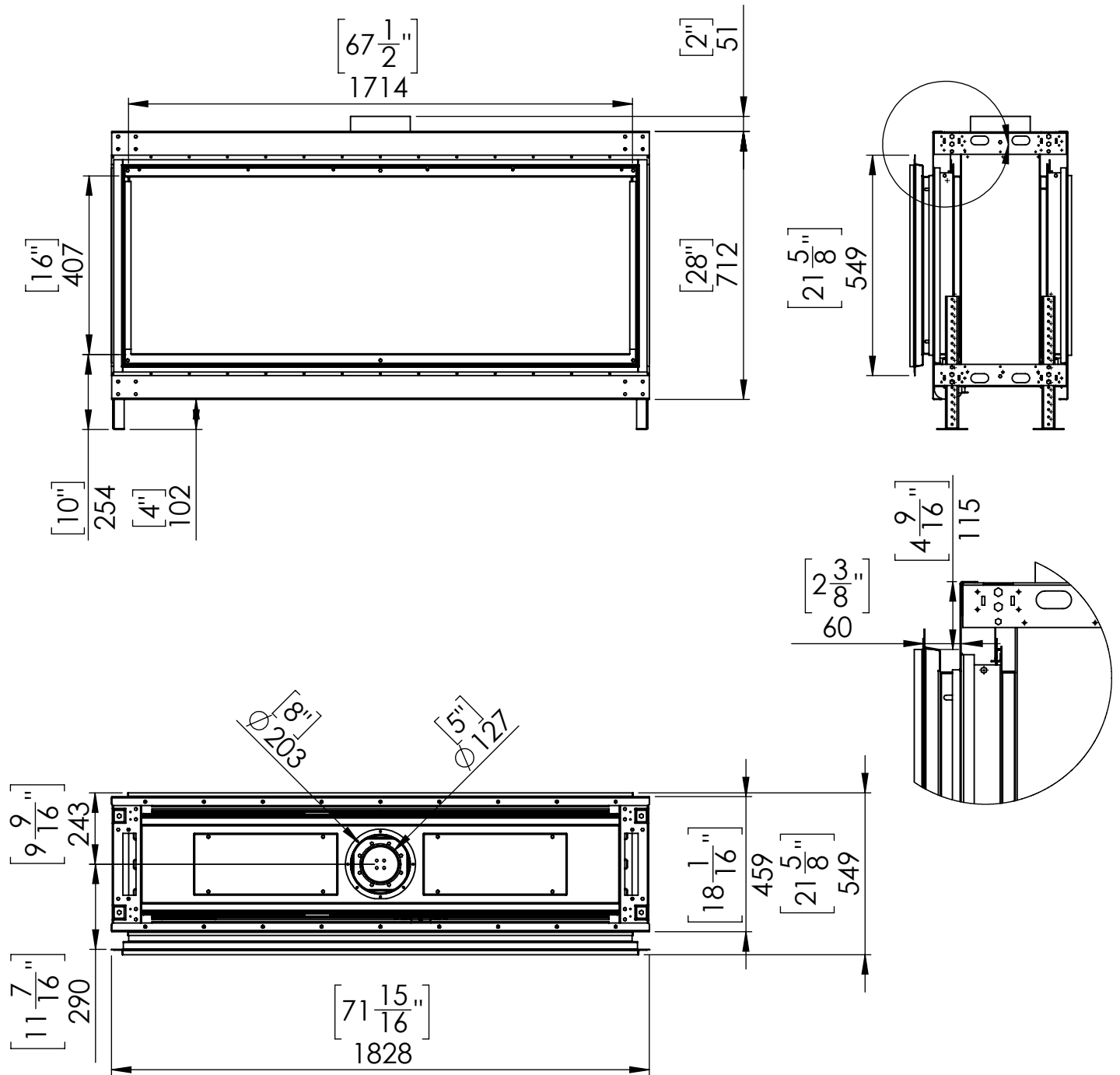

Telescopic legs ranges
(from bottom of glass): 10"-19"

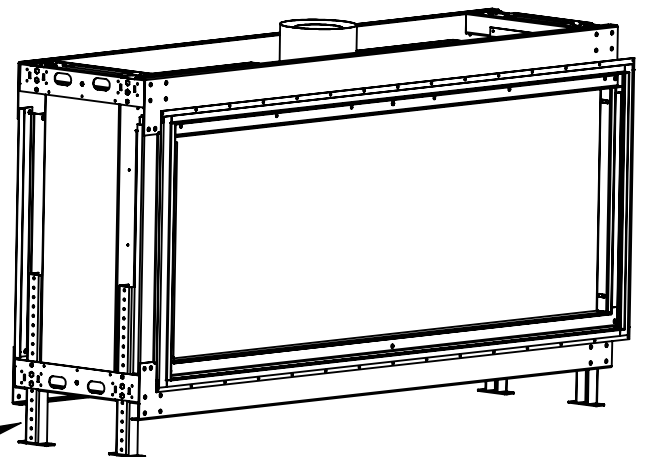

Flat installtion - option 1

Recess installtion - option 1

Metal studs **surrounding all sides** of Fireplace

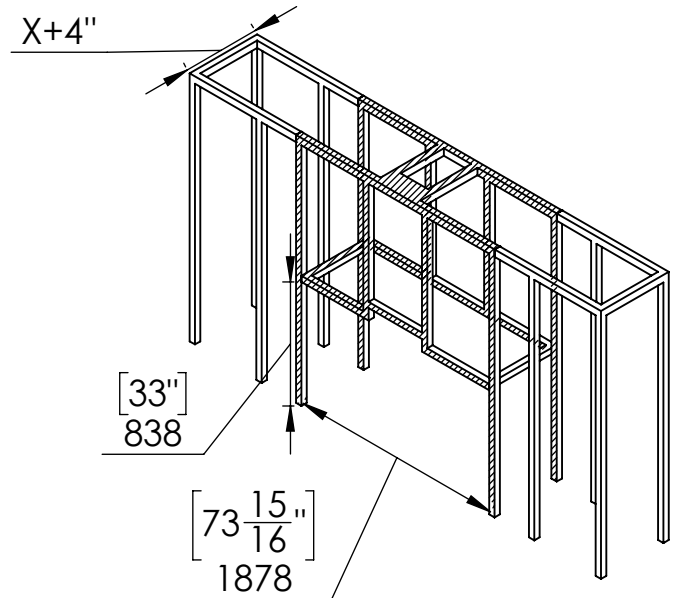
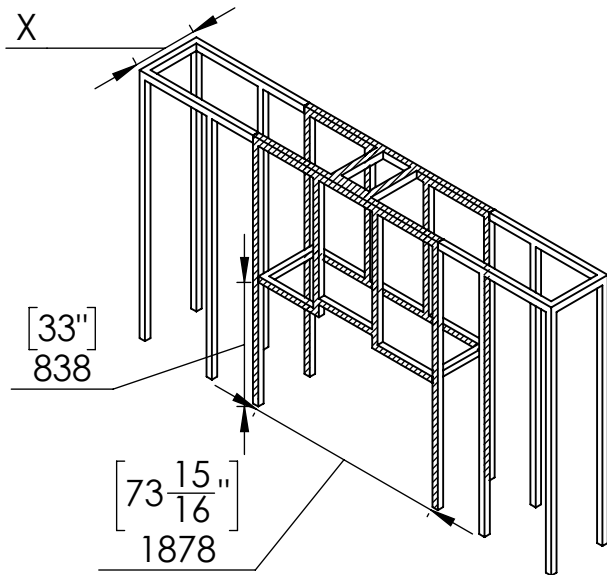

▨ Metal stud

▨ Metal stud

Flat installtion - option 2

Recess installtion - option 2

Metal studs **above** the Fireplace **only**

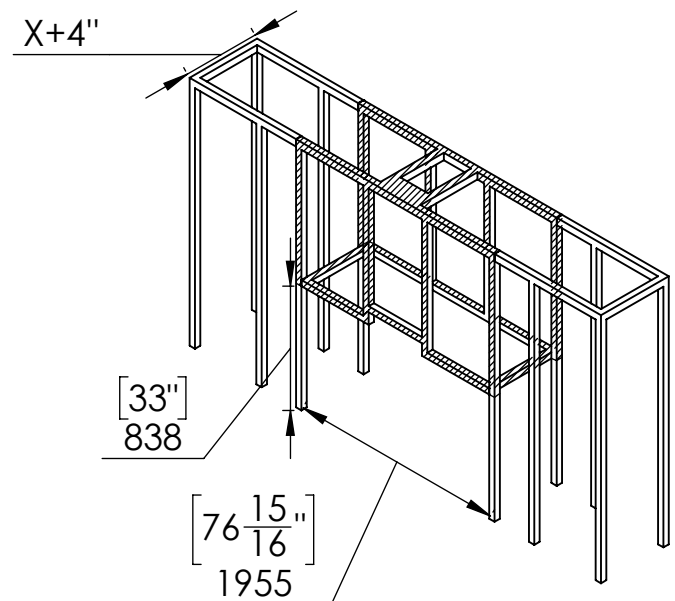
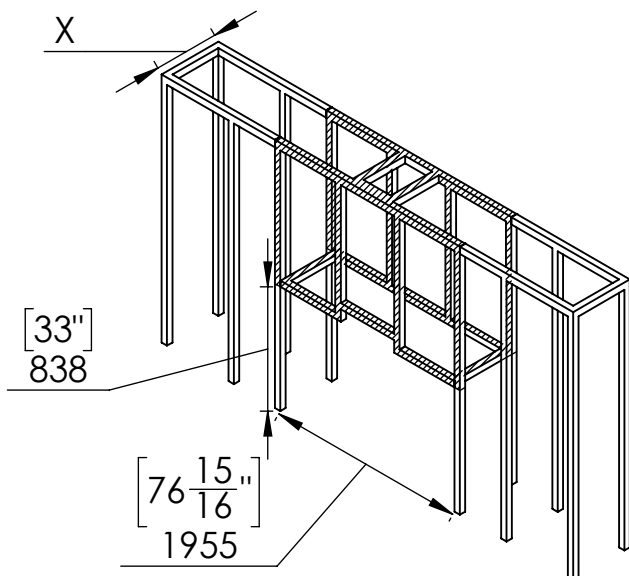

▨ Metal stud
□ Coverd Wood stud

▨ Metal stud
□ Coverd Wood stud

External Cement Board Opening

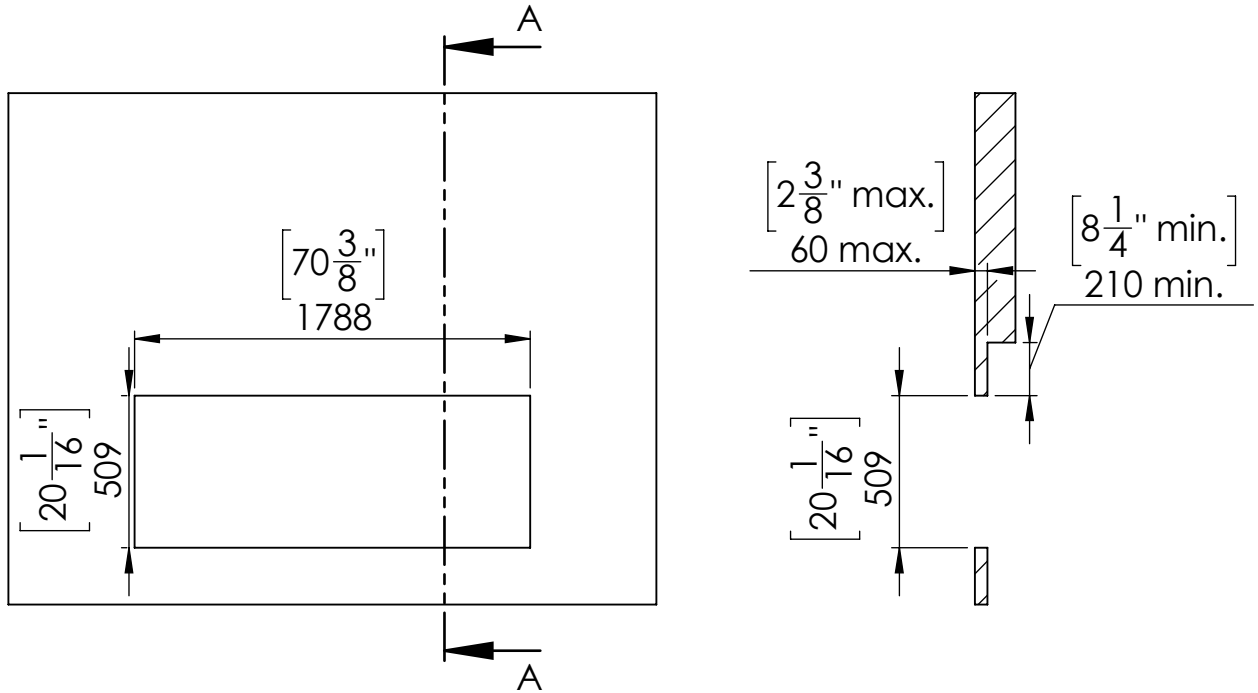

Outdoor Kit - External Frame

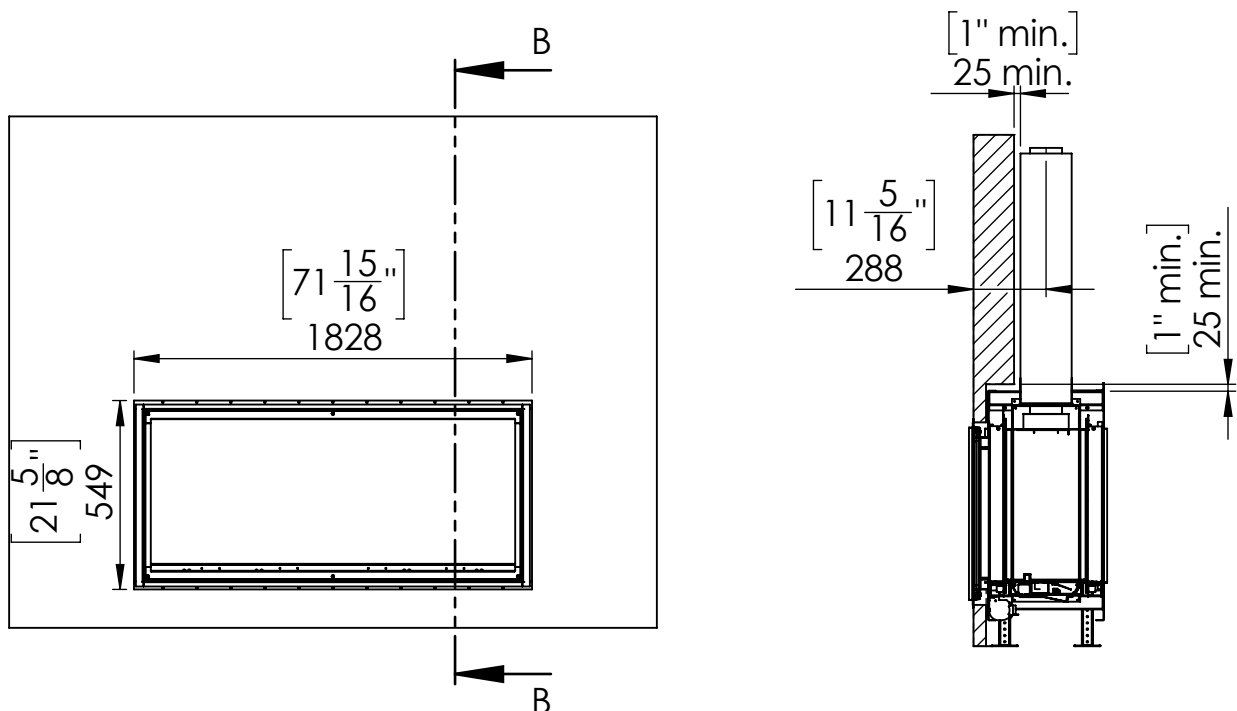

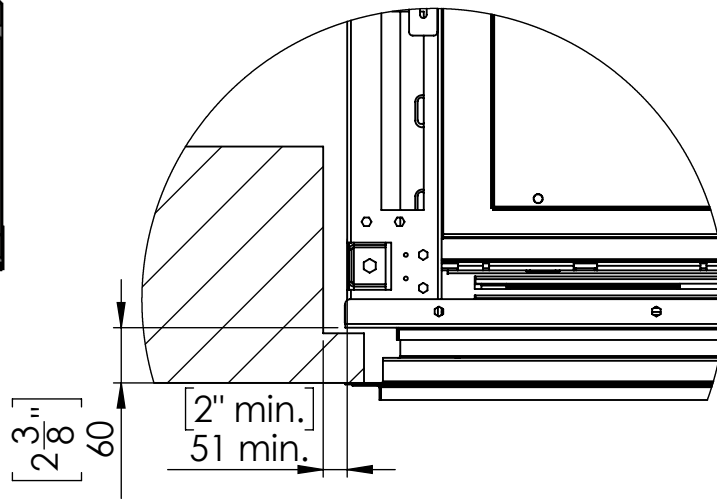
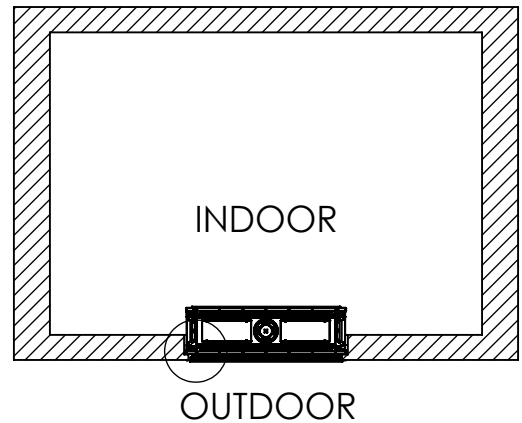
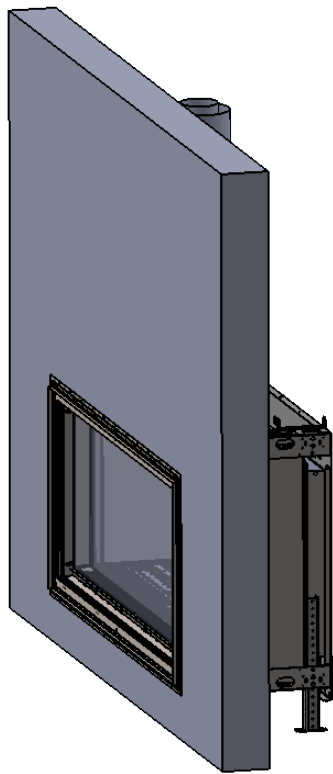

Specifications for Appliance Flare See Through 70

| Factor | NG | LPG |
|-------------------------|-----------------|-----------------------|
| Burner Type | 35,80,35 | 35,80,35 |
| Orifice | 500,1000,500 | 160,180,160 |
| BTU Max. | 52200 | 43000 |
| BTU min. | 28000 | 20000 |
| Kw/h | 15.3k | 12.6k |
| Chimney DIA. | 5X8 | 5X8 |
| Manifold Pressure[w.c] | 3.6 | 8.8 |
| Efficiency rate | 82 | 79 |
| Glass Size Length\Width | 1770.5 X 420 mm | 69" 11/16 X 16" 8/16' |
| Appliance Weigh | 190Kg | 418lb |